

510 MT Wellington Highway

T601 | 510 MT Wellington | Marketing

Prepared by Taylored Studio for Centuria



LEGAL / SITE INFORMATION

Legal Description

Lot 1 DP 101490, Lot 2 DP 103564

Site Address

510 MT Wellington Highway Mount Wellington Auckland 1060

Site Area

3.0845 hectare

Affected Building Gross Area

11,845m²

Planning

Zone: Business - Light Industry Zone

EXISTING GFA SUMMARY

WAREHOUSE	8,710.5m ²
WAREHOUSE BREAKOUT SPACE	78.4m ²
RETAIL EXTENSION	322m ²
EXISTING BREEZEWAY	2,028.4m ²
EXISTING MEZANNINE	190.8m ²
GF OFFICE+RETAIL & AMENITIES	2,260.8m ²
1F OFFICE & AMENITIES	1,541m ²

CAR PARKING

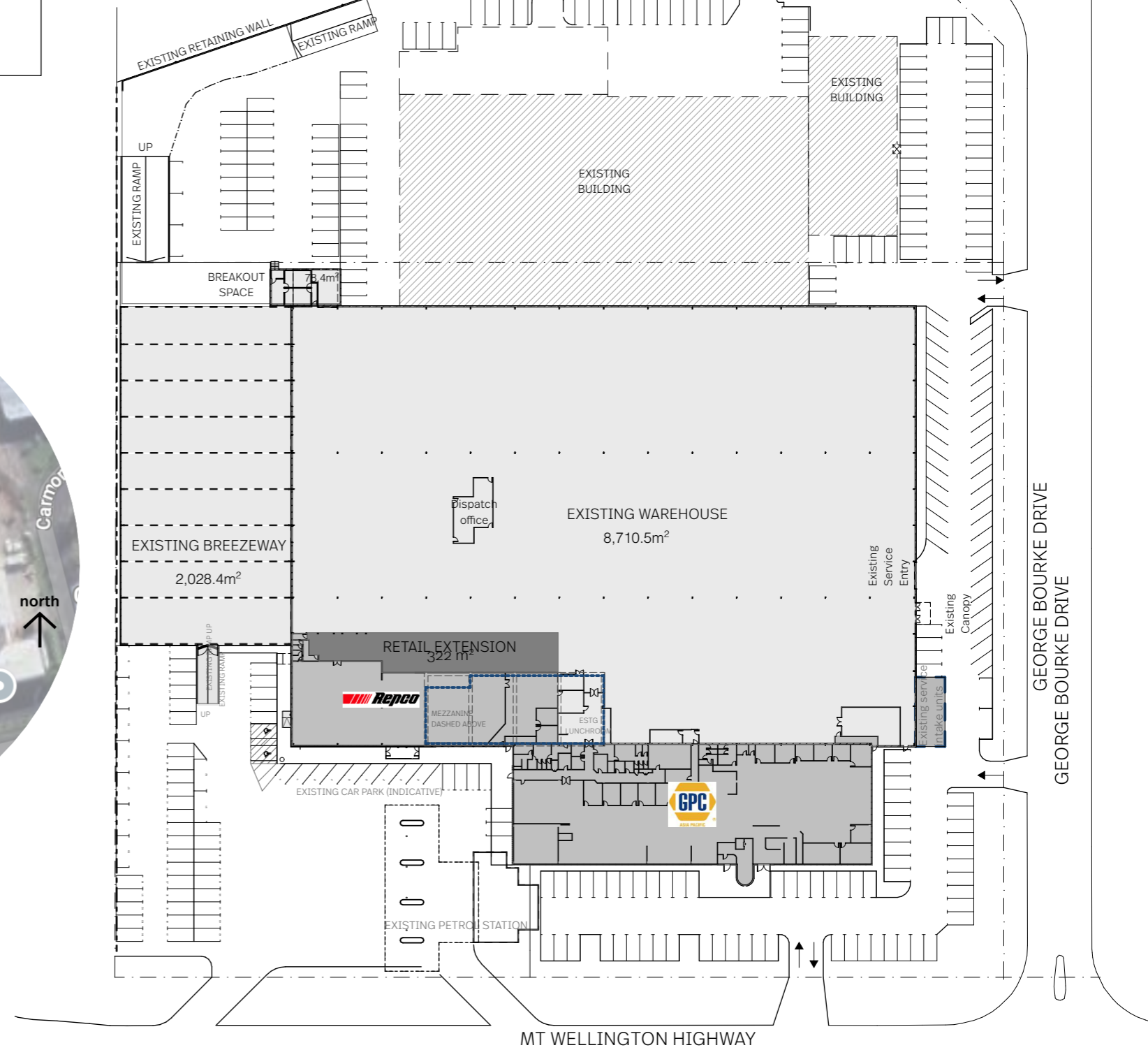

Aerial Plan
NTS

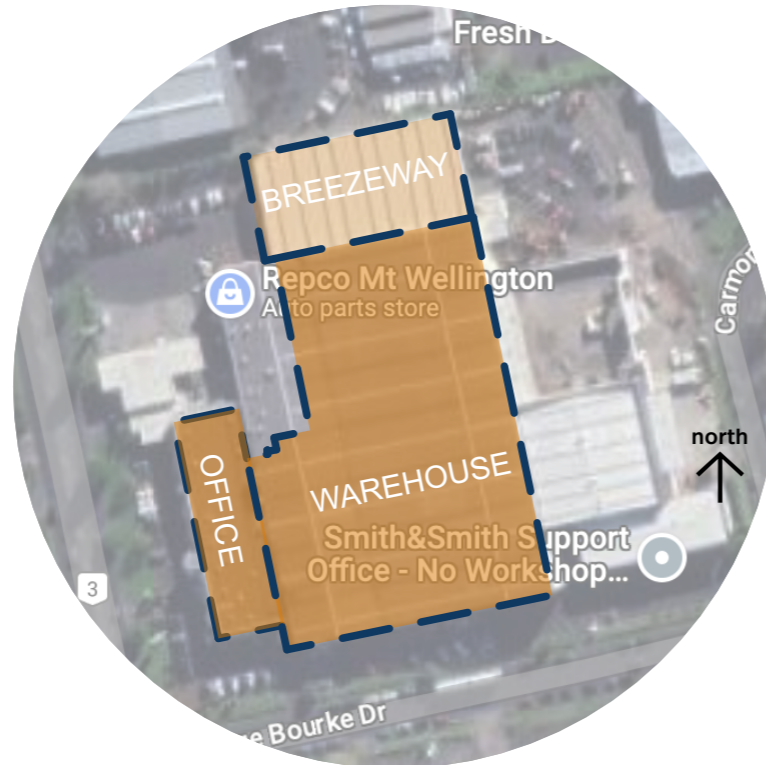

Locality Plan
NTS

General Notes

NOTE: It is the responsibility of the contractor to verify all dimensions on site prior to commencing all work. The contractor is to ensure that all work complies with the New Zealand Building Code, all amendments thereof and all relevant New Zealand Standards. All proprietary items and materials shall be fixed and applied in strict accordance with manufacturers specifications. TAYLORED architecture & environments Ltd under no circumstances accepts responsibility for payment of any products or services specified.

80 Hinemoa Street Birkenhead Auckland 0626

Job Title

T601 | 510 MT Wellington

Site

510 MT Wellington Highway Mount Wellington Auckland 1060

Drawing Name

existing site plan

Scale

1:1000, 1:500 @ A3

Revision

A

Drawing No.

01

Date

25/10/23

north



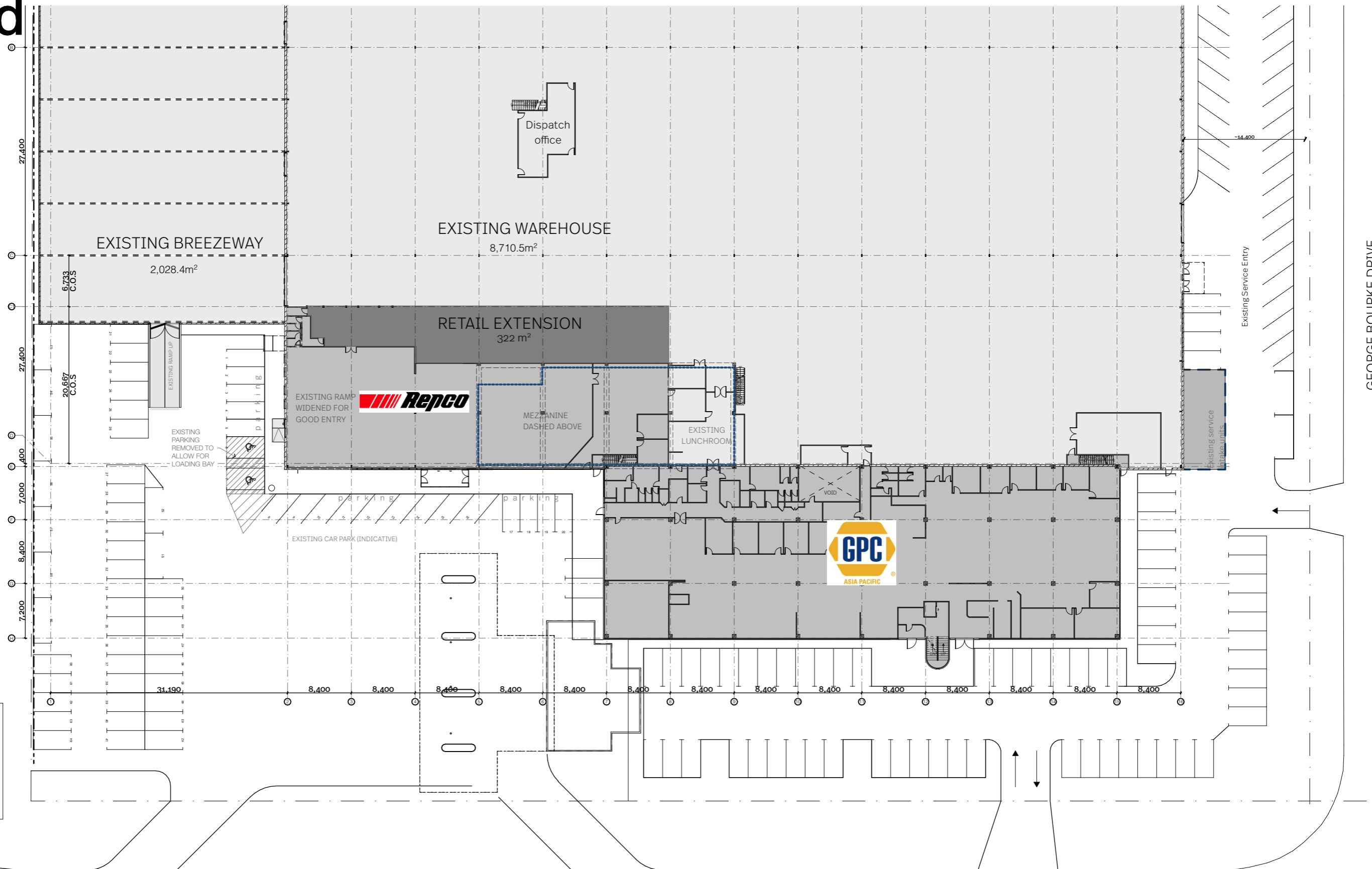

EXISTING GFA SUMMARY	
WAREHOUSE	8,710.5m ²
WAREHOUSE BREAKOUT SPACE	78.4m ²
RETAIL EXTENSION	322m ²
EXISTING BREEZEWAY	2,028.4m ²
EXISTING MEZANNINE	190.8m ²
GF OFFICE+RETAIL & AMENITIES	2,260.8m ²
1F OFFICE & AMENITIES	1,541m ²
CAR PARKING	
EXISTING CARPARK TOTAL	93

General Notes

NOTE: It is the responsibility of the contractor to verify all dimensions on site prior to commencing all work. The contractor is to ensure that all work complies with the New Zealand Building Code, all amendments thereof and all relevant New Zealand Standards. All proprietary items and materials shall be fixed and applied in strict accordance with manufacturers specifications. TAYLORED architecture & environments Ltd under no circumstances accepts responsibility for payment of any products or services specified.

80 Hinemoa Street Birkenhead Auckland 0626

Job Title

T601 | 510 MT Wellington

Site

510 MT Wellington Highway Mount Wellington Auckland 1060

Drawing Name

existing ground floor plan

Scale

1:500 @ A3

Revision

A

Drawing No.

02

Date

25/10/23

north

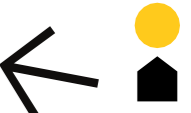

GEORGE BOURKE DRIVE

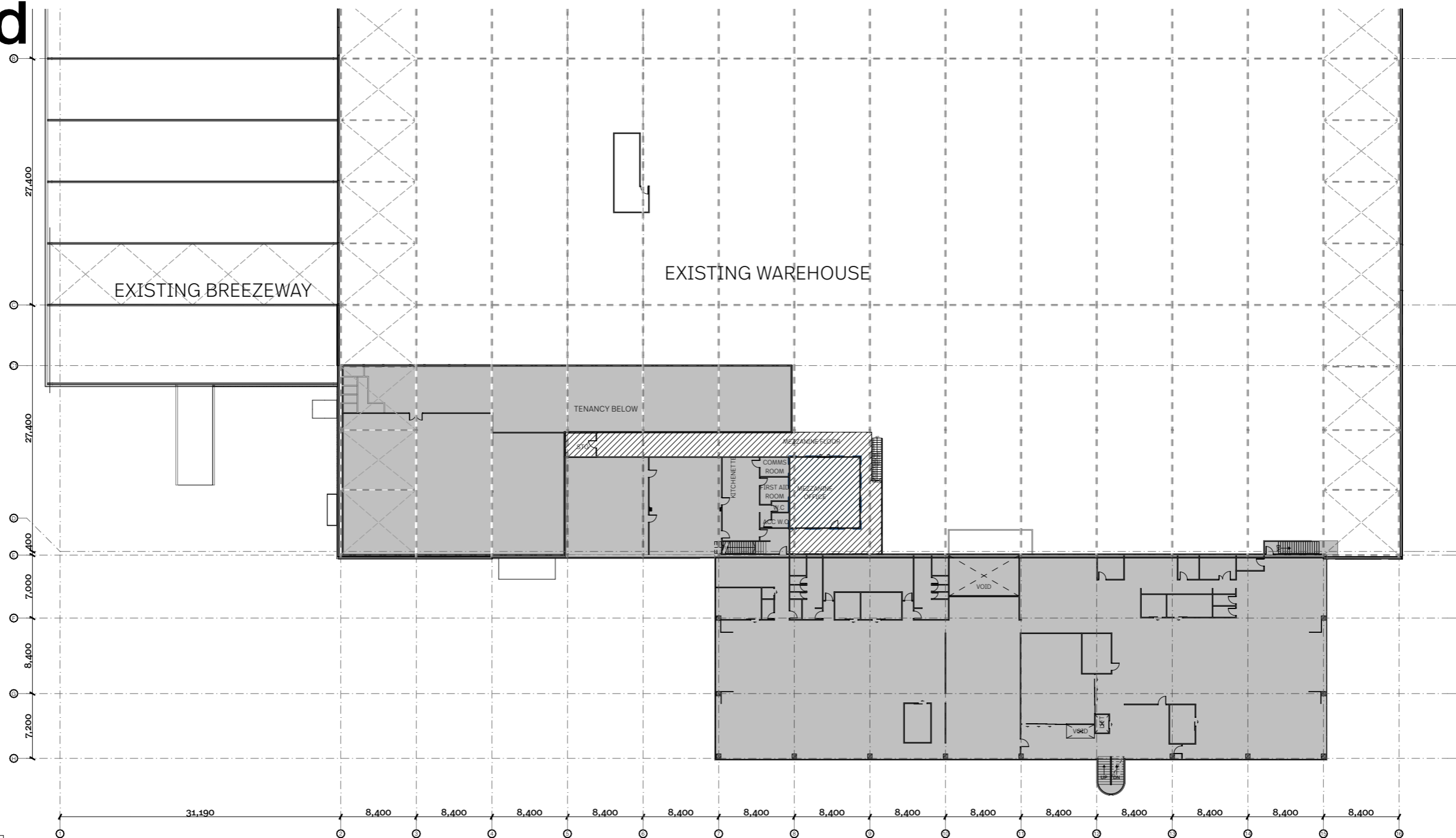

EXISTING GFA SUMMARY	
WAREHOUSE	8,710.5m ²
WAREHOUSE BREAKOUT SPACE	78.4m ²
RETAIL EXTENSION	322m ²
EXISTING BREEZEWAY	2,028.4m ²
EXISTING MEZANNINE	190.8m ²
GF OFFICE+RETAIL & AMENITIES	2,260.8m ²
1F OFFICE & AMENITIES	1,541m ²
CAR PARKING	
EXISTING CARPARK TOTAL	93

General Notes

NOTE: It is the responsibility of the contractor to verify all dimensions on site prior to commencing all work. The contractor is to ensure that all work complies with the New Zealand Building Code, all amendments thereof and all relevant New Zealand Standards. All proprietary items and materials shall be fixed and applied in strict accordance with manufacturers specifications. TAYLORED architecture & environments Ltd under no circumstances accepts responsibility for payment of any products or services specified.

80 Hinemoa Street Birkenhead Auckland 0626

Job Title

T601 | 510 MT Wellington

Site

510 MT Wellington Highway Mount
Wellington Auckland 1060

Drawing Name

existing first floor plan

Scale

1:500 @ A3

Revision

A

Drawing No.

03

Date

25/10/23

north



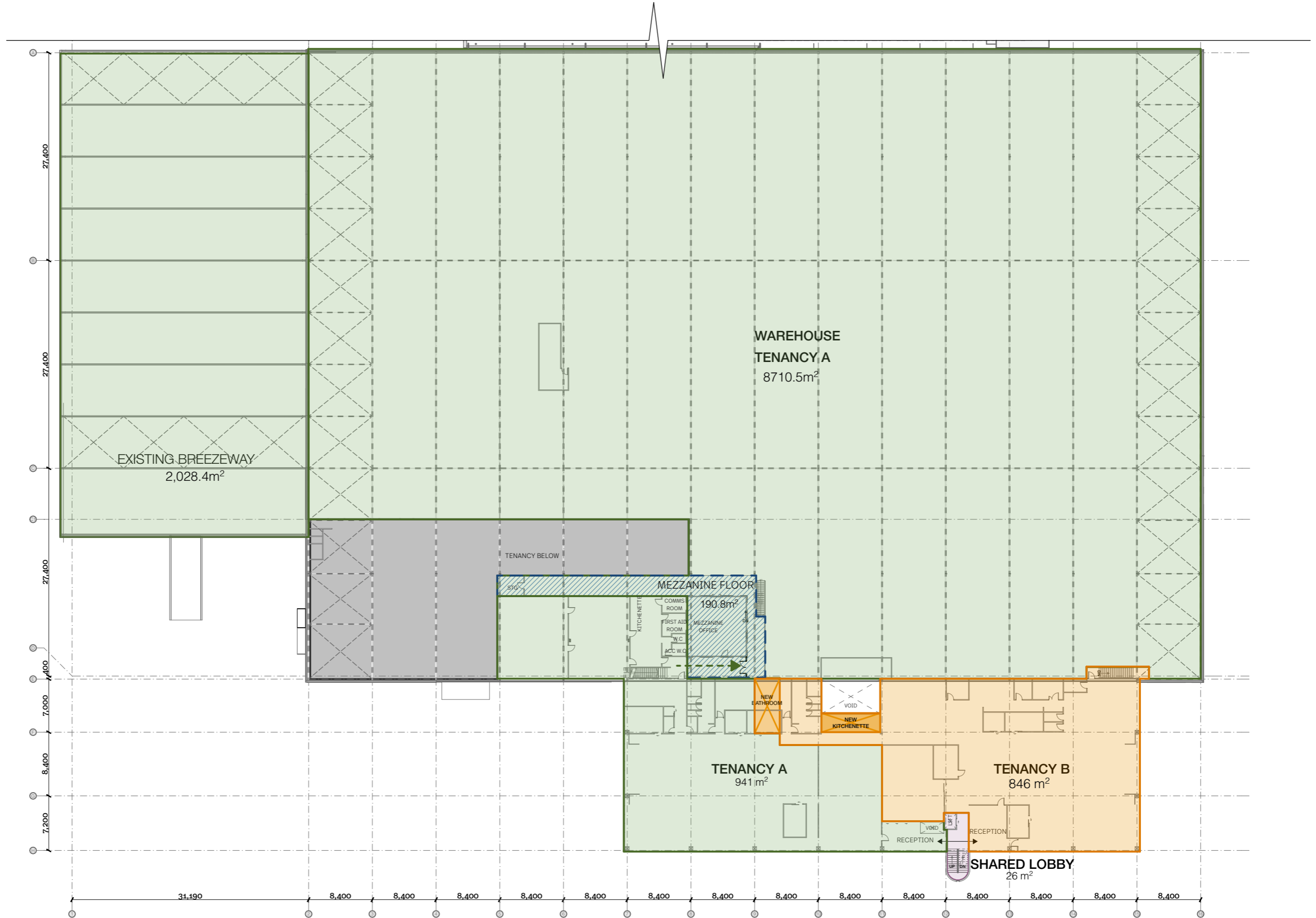

OPTION B AREA SCHEDULE	
TENANCY A	
GF	
WAREHOUSE	8710.5m ²
WAREHOUSE BREAKOUT SPACE	78.4m ²
EXISTING BREEZEWAY	2,028.4m ²
1F	
OFFICE & AMENITIES	932m ²
MEZZANINE FLOOR	190.8m ²
TENANCY B	
1F	
OFFICE & AMENITIES	846m ²
SHARED LOBBY	26m ²
OPTION B IMPROVEMENT SCHEDULE	
TENANCY A	
NEW ACCESS TO MEZZANINE	
TENANCY B	
NEW KITCHENETTE	TBDm ²
NEW BATHROOM	TBDm ²

General Notes

NOTE: It is the responsibility of the contractor to verify all dimensions on site prior to commencing all work. The contractor is to ensure that all work complies with the New Zealand Building Code, all amendments thereof and all relevant New Zealand Standards. All proprietary items and materials shall be fixed and applied in strict accordance with manufacturers specifications. TAYLORED architecture & environments Ltd under no circumstances accepts responsibility for payment of any products or services specified.

80 Hinemoa Street Birkenhead Auckland 0626

Job Title

T601 | 510 MT Wellington

Site

510 MT Wellington Highway Mount Wellington Auckland 1060

Drawing Name

proposed first floor floor plan OPT A

Scale

1:500 @ A3

Revision

A

Drawing No.

04

Date

25/10/23

north



OPTION B AREA SCHEDULE		OPTION B IMPROVEMENT SCHEDULE	
TENANCY A			
GF			
WAREHOUSE	8710.5m ²		
WAREHOUSE BREAKOUT SPACE	78.4m ²		
EXISTING BREEZEWAY	2,028.4m ²		
1F			
OFFICE & AMENITIES	932m ²		
MEZZANINE FLOOR	190.8m ²		
TENANCY B			
1F			
OFFICE & AMENITIES	846m ²		
SHARED LOBBY	26m ²		
		TENANCY A	
		NEW ACCESS TO MEZZANINE	
		TENANCY B	
		NEW KITCHENETTE	TBDm ²
		NEW BATHROOM	TBDm ²

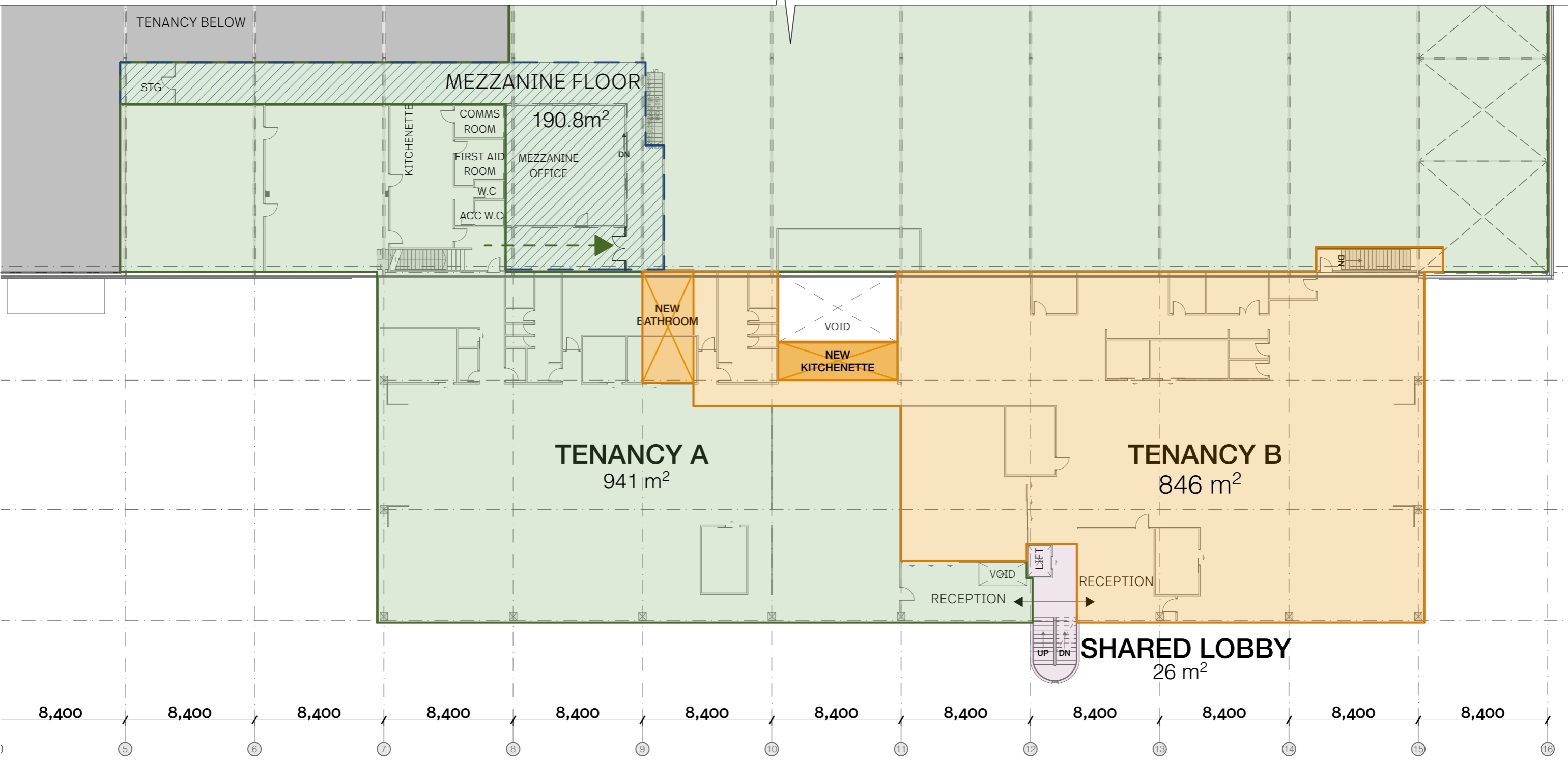

General Notes

NOTE: It is the responsibility of the contractor to verify all dimensions on site prior to commencing all work. The contractor is to ensure that all work complies with the New Zealand Building Code, all amendments thereof and all relevant New Zealand Standards. All proprietary items and materials shall be fixed and applied in strict accordance with manufacturers specifications. TAYLORED architecture & environments Ltd under no circumstances accepts responsibility for payment of any products or services specified.

80 Hinemoa Street Birkenhead Auckland 0626

Job Title

T601 | 510 MT Wellington

Site

510 MT Wellington Highway Mount Wellington Auckland 1060

Drawing Name

proposed first floor plan OPT A

Scale

1:250 @ A3

Revision

A

Drawing No.

05

Date

25/10/23



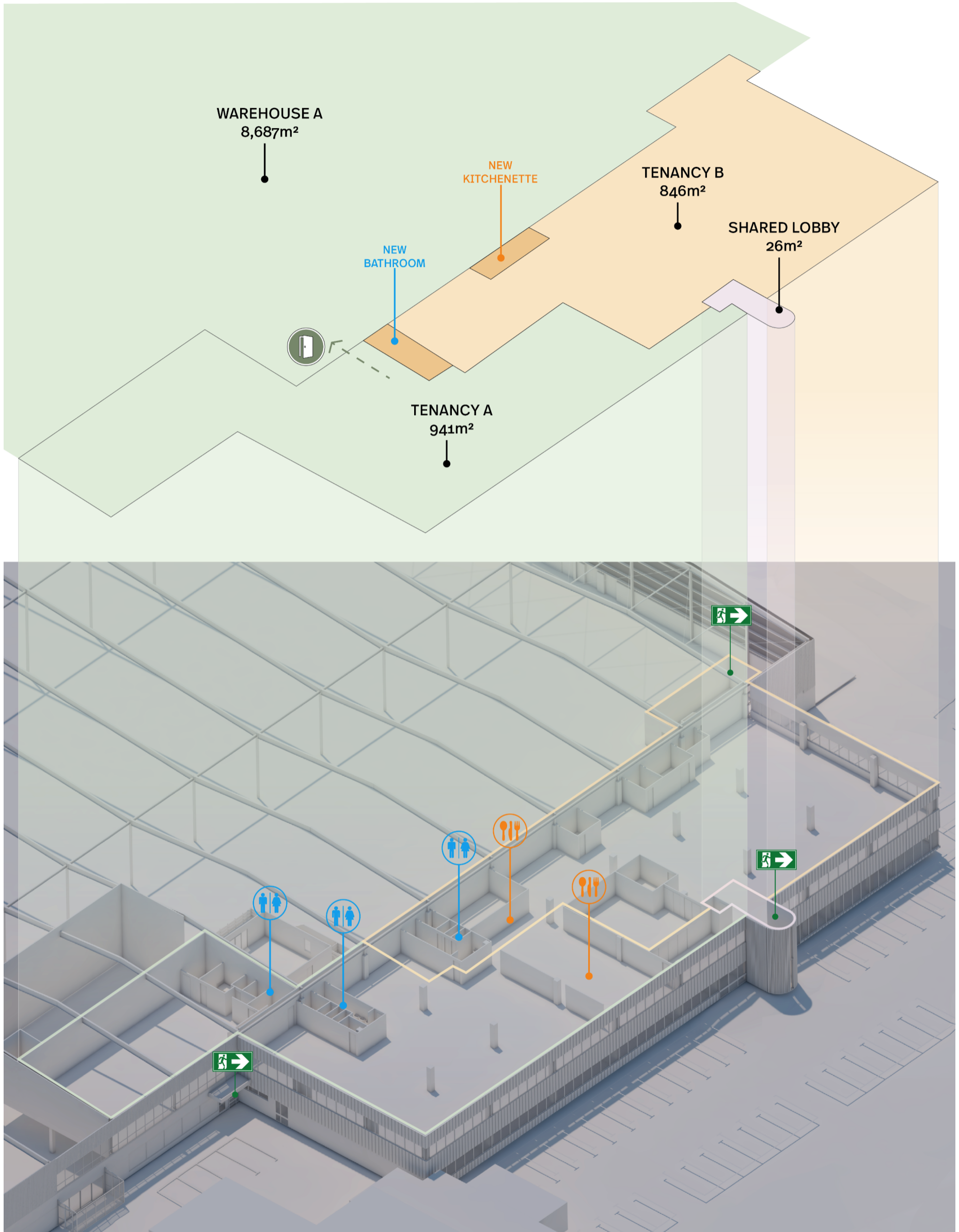

Job Title

T601 | 510 MT Wellington

Site

510 MT Wellington Highway Mount
Wellington Auckland 1060

80 Hinemoa Street Birkenhead Auckland 0626

Drawing Name

OPT A 3D imagery AXO

Scale

1:1.7241 @ A3

Revision

A

Drawing No.

06

Date

25/10/23

north



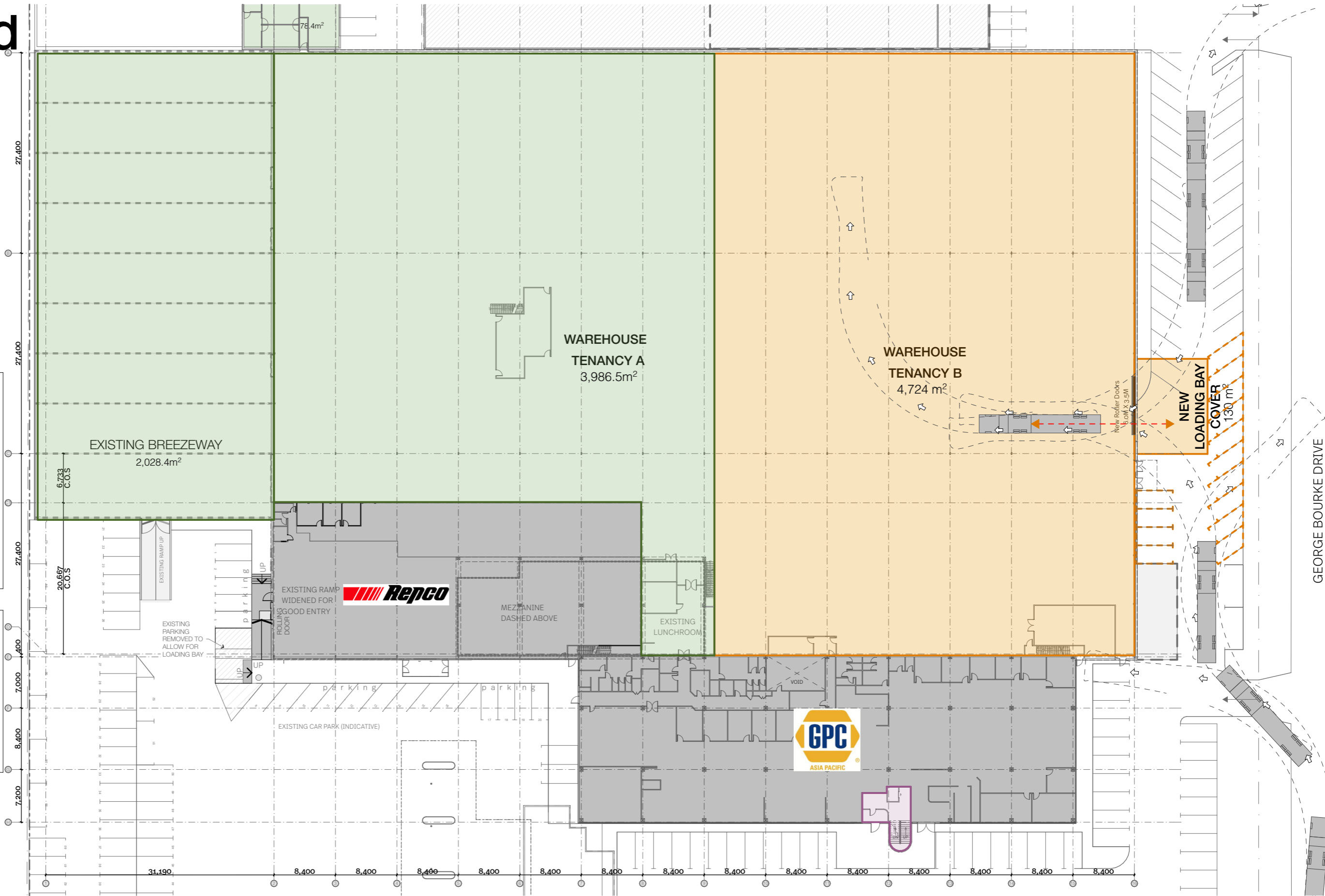

OPTION B AREA SCHEDULE	
TENANCY A	
GF	
WAREHOUSE	3,986.5m ²
WAREHOUSE BREAKOUT SPACE	78.4m ²
EXISTING BREEZEWAY	2,028.4m ²
1F	
OFFICE & AMENITIES	936m ²
MEZZANINE FLOOR	190.8m ²
TENANCY B	
GF	
WAREHOUSE	4,724m ²
NEW LOADING COVER	130m ²
1F	
OFFICE & AMENITIES	851m ²
NEW MEZZANINE ADDITION	19m ²
SHARED LOBBY	26m²

OPTION B IMPROVEMENT SCHEDULE	
TENANCY A	
NEW ACCESS TO MEZZANINE	
TENANCY B	
NEW LOADING COVER	
EXISTING CARPARK REMOVED	13 CAR
PARKS	
NEW ROLLER DOOR	6.0MX3.5M
NEW KITCHENETTE	TBDm ²
NEW BATHROOM	TBDm ²
NEW MEZZANINE	19m ²
NEW STAIRWAY TO MEZZANINE	
NEW ACCESS TO MEZZANINE	

General Notes

NOTE: It is the responsibility of the contractor to verify all dimensions on site prior to commencing all work. The contractor is to ensure that all work complies with the New Zealand Building Code, all amendments thereof and all relevant New Zealand Standards. All proprietary items and materials shall be fixed and applied in strict accordance with manufacturers specifications. TAYLORED architecture & environments Ltd under no circumstances accepts responsibility for payment of any products or services specified.

80 Hinemoa Street Birkenhead Auckland 0626

Job Title

T601 | 510 MT Wellington

Site

510 MT Wellington Highway Mount Wellington Auckland 1060

Drawing Name

proposed ground floor plan OPT B

Scale

1:500 @ A3

Revision

A

Drawing No.

07

Date

25/10/23



OPTION B AREA SCHEDULE	
TENANCY A	
GF	
WAREHOUSE	3,986.5m ²
WAREHOUSE BREAKOUT SPACE	78.4m ²
EXISTING BREEZEWAY	2,028.4m ²
1F	
OFFICE & AMENITIES	936m ²
MEZZANINE FLOOR	190.8m ²
TENANCY B	
GF	
WAREHOUSE	4,724m ²
NEW LOADING COVER	130m ²
1F	
OFFICE & AMENITIES	851m ²
NEW MEZZANINE ADDITION	19m ²
SHARED LOBBY	
	26m ²

OPTION B IMPROVEMENT SCHEDULE	
TENANCY A	
NEW ACCESS TO MEZZANINE	
TENANCY B	
NEW LOADING COVER	
EXISTING CARPARK REMOVED	13 CAR
PARKS	
NEW ROLLER DOOR	6.0MX3.5M
NEW KITCHENETTE	TBDm ²
NEW BATHROOM	TBDm ²
NEW MEZZANINE	19m ²
NEW STAIRWAY TO MEZZANINE	
NEW ACCESS TO MEZZANINE	

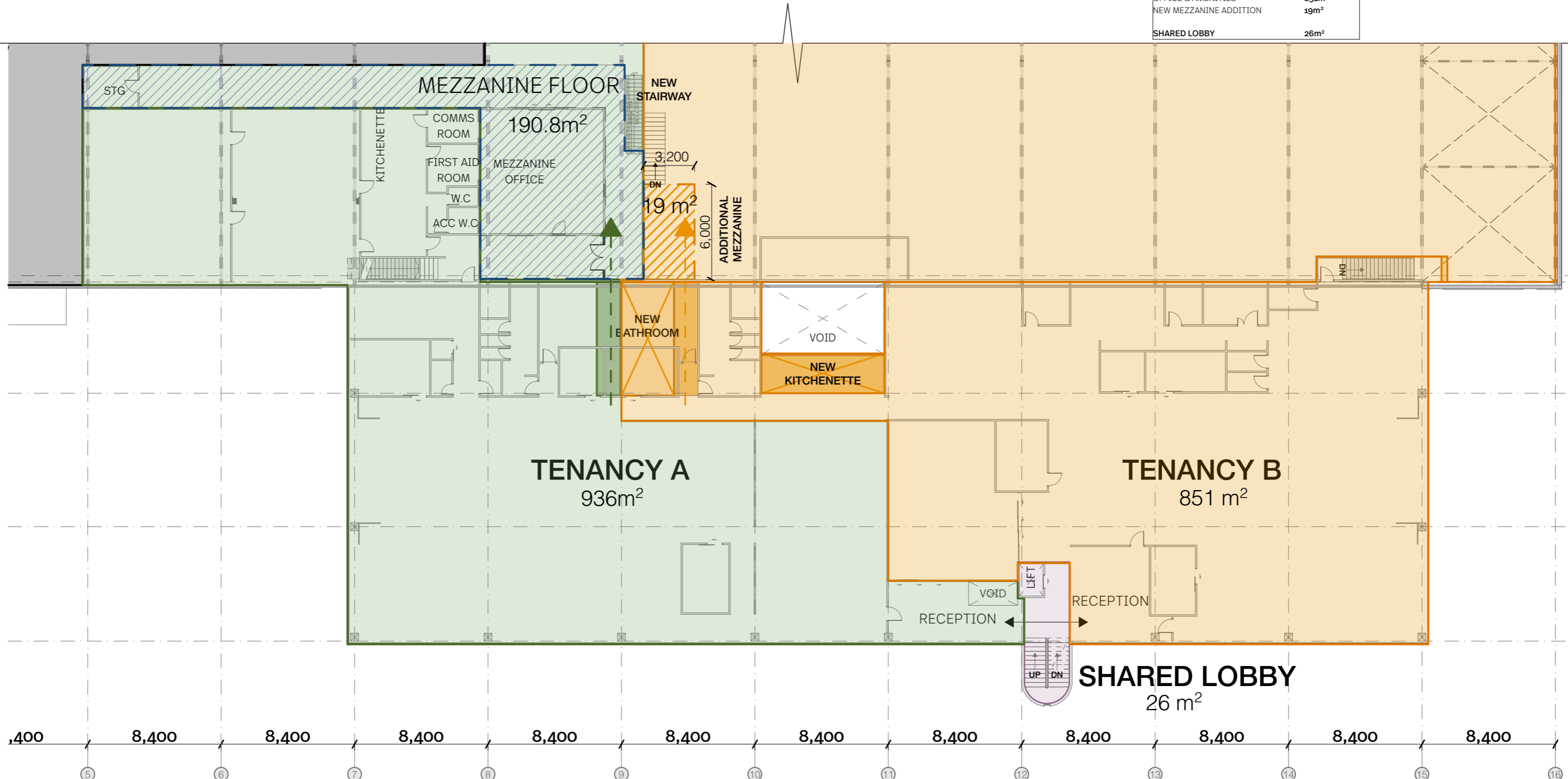

General Notes

NOTE: It is the responsibility of the contractor to verify all dimensions on site prior to commencing all work. The contractor is to ensure that all work complies with the New Zealand Building Code, all amendments thereof and all relevant New Zealand Standards. All proprietary items and materials shall be fixed and applied in strict accordance with manufacturers specifications. TAYLORED architecture & environments Ltd under no circumstances accepts responsibility for payment of any products or services specified.

80 Hinemoa Street Birkenhead Auckland 0626

Job Title	Drawing Name	Revision	Date
T601 510 MT Wellington	proposed first floor floor plan OPT B	A	25/10/23
Site	Scale	Drawing No.	
510 MT Wellington Highway Mount Wellington Auckland 1060	1:250 @ A3	08	



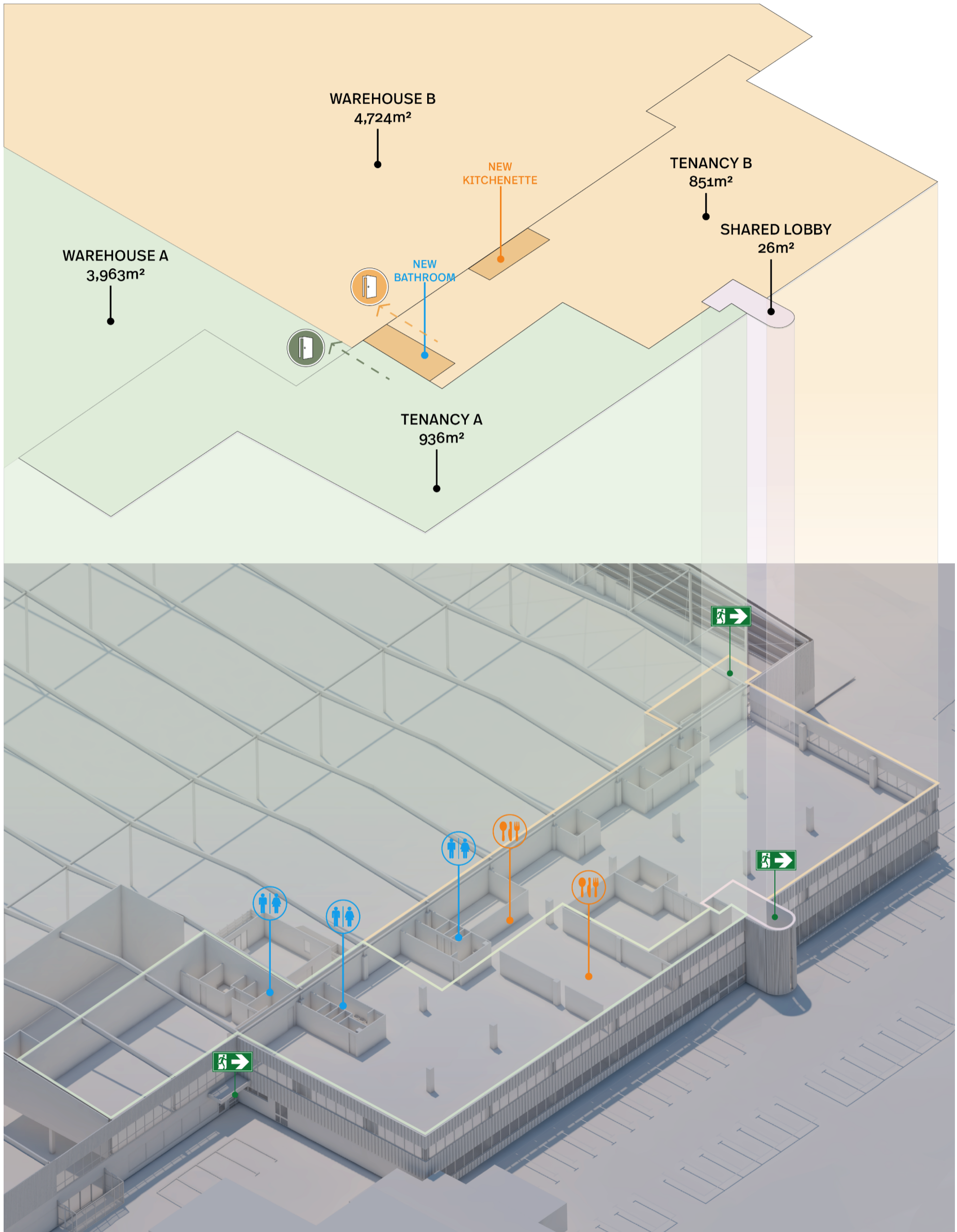

Job Title _____

T601 | 510 MT Wellington

Site _____

510 MT Wellington Highway Mount Wellington Auckland 1060

80 Hinemoa Street Birkenhead Auckland 0626

Drawing Name _____

OPT B 3D imagery AXO

Scale _____

1:1.7241 @ A3

Revision _____

A

Drawing No. _____

09

Date _____

25/10/23

north



OPTION C AREA SCHEDULE	
TENANCY A	
GF	8710.5m ²
WAREHOUSE	78.4m ²
WAREHOUSE BREAKOUT SPACE	2,028.4m ²
EXISTING BREEZEWAY	
1F	
OFFICE & AMENITIES	273m ²
MEZZANINE FLOOR	190.8m ²
TENANCY B	
1F	
OFFICE & AMENITIES	798m ²
TENANCY C	
1F	
OFFICE & AMENITIES	716m ²
SHARED LOBBY	26m ²

OPTION C IMPROVEMENT SCHEDULE	
TENANCY A	
NEW ACCESS TO MEZZANINE	
TENANCY B	
NEW KITCHENETTE	TBDm ²
NEW BATHROOM	TBDm ²

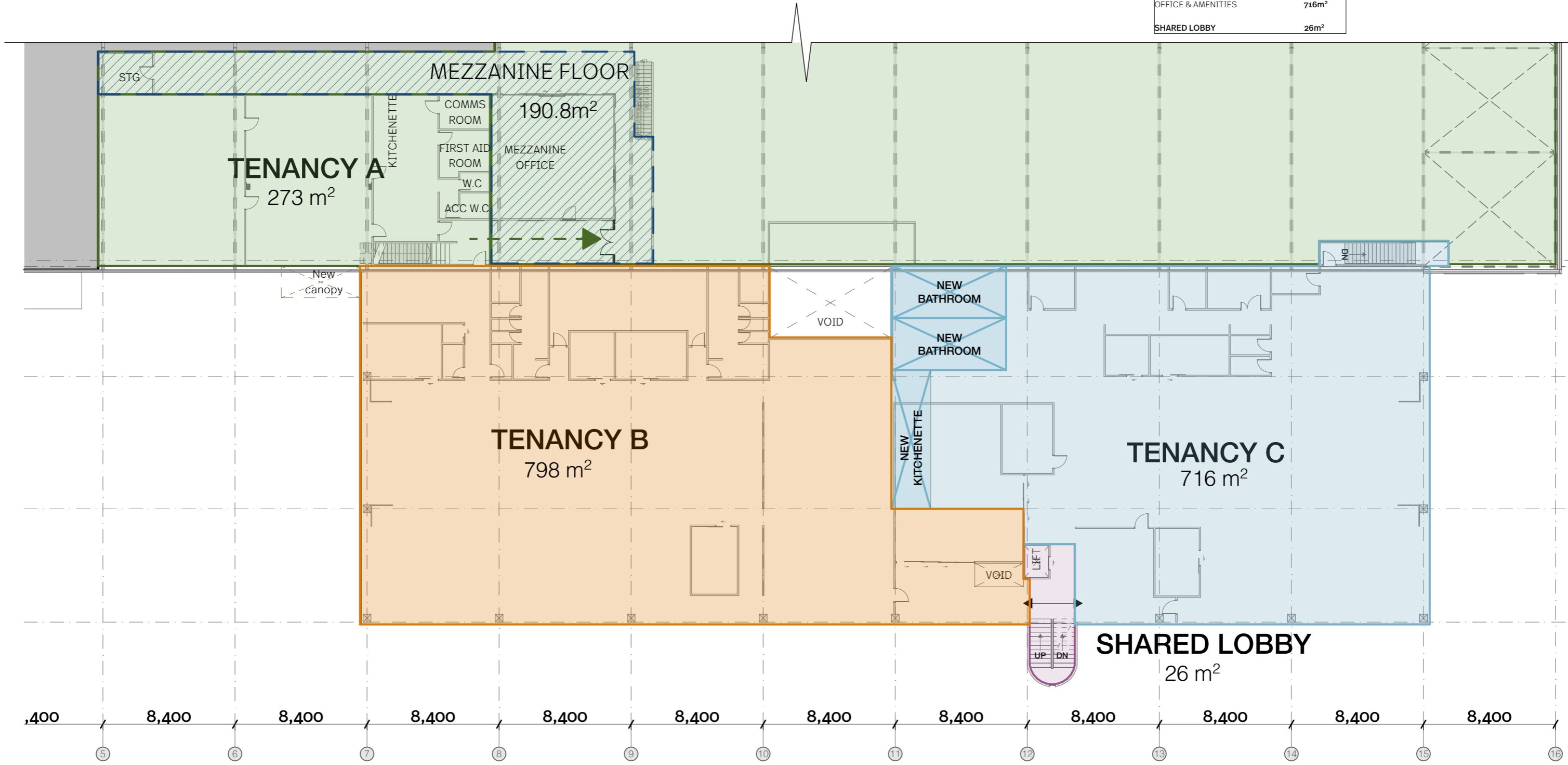

General Notes

NOTE: It is the responsibility of the contractor to verify all dimensions on site prior to commencing all work. The contractor is to ensure that all work complies with the New Zealand Building Code, all amendments thereof and all relevant New Zealand Standards. All proprietary items and materials shall be fixed and applied in strict accordance with manufacturers specifications. TAYLORED architecture & environments Ltd under no circumstances accepts responsibility for payment of any products or services specified.

80 Hinemoa Street Birkenhead Auckland 0626

Job Title

T601 | 510 MT Wellington

Site

510 MT Wellington Highway Mount Wellington Auckland 1060

Drawing Name

proposed first floor floor plan OPT C

Scale

1:250 @ A3

Revision

A

Drawing No.

10

Date

25/10/23



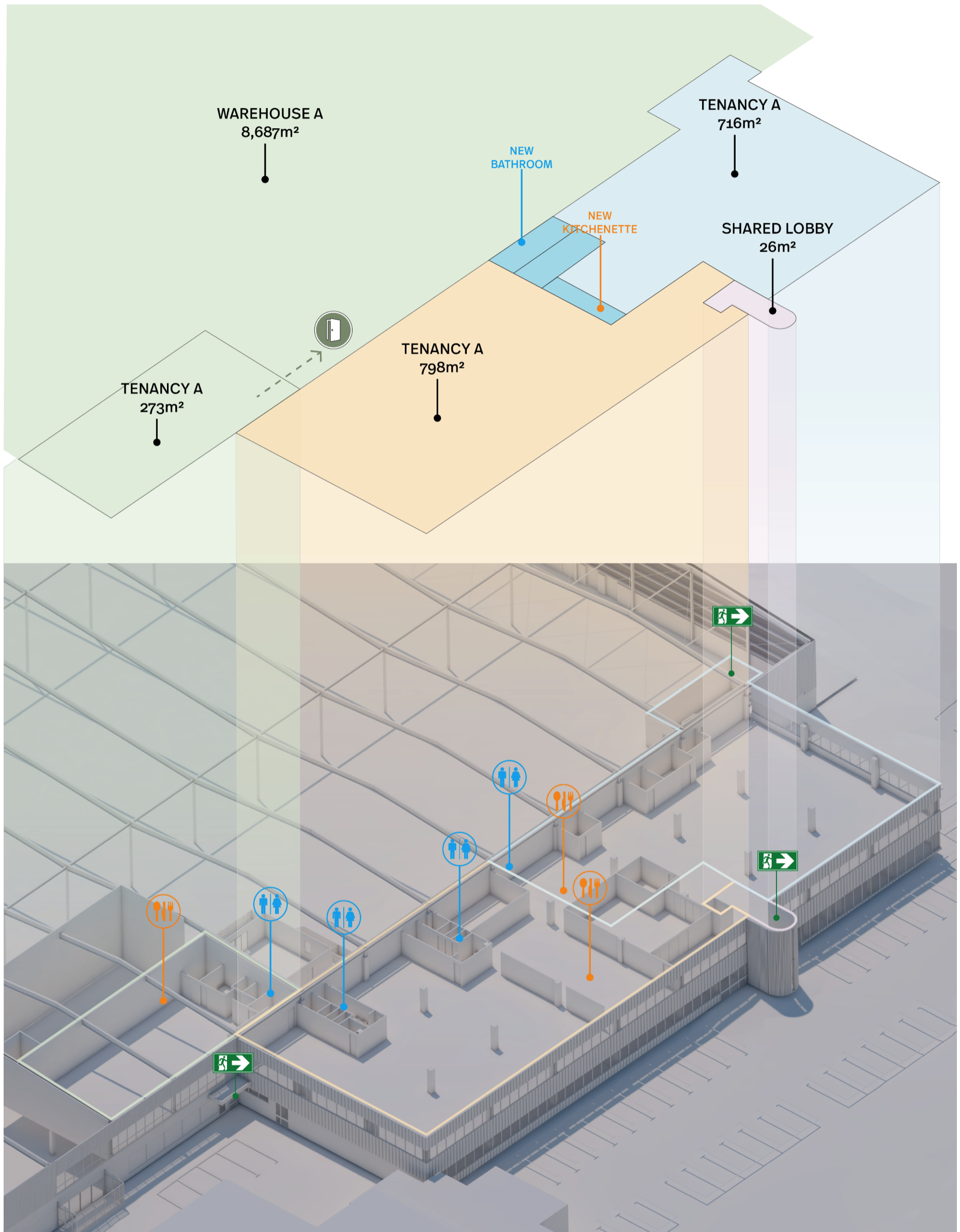

Job Title

T601 | 510 MT Wellington

Site

510 MT Wellington Highway Mount
Wellington Auckland 1060

80 Hinemoa Street Birkenhead Auckland 0626

Drawing Name

OPT C 3D imagery AXO

Scale

1:1.7241 @ A3

Revision

A

Drawing No.

11

Date

25/10/23

north



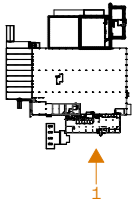

Perspective 1

ARTIST IMPRESSION ONLY



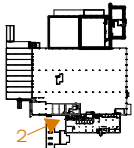

Perspective 2

ARTIST IMPRESSION ONLY



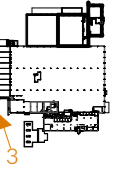

Perspective 3

ARTIST IMPRESSION ONLY

